

GAPS UP TO 1" MAX (PLAN VIEW)
FLASHING INSTALLED BEFORE WRB

BLUESKIN METAL CLAD
LAP AIR BARRIER 2" ONTO FLASHING

BLUESKIN METAL CLAD
(SEE CONCAVE LOOP FLASHING DETAIL)

CREATE CONCAVE LOOP IN MEMBRANE BY LOOPING INTO GAP. PRIOR TO INSTALLATION, ADHERE MEMBRANE TO ITSELF AND INSTALL TO PREVENT ADHESION TO SURFACES WITHIN GAP.

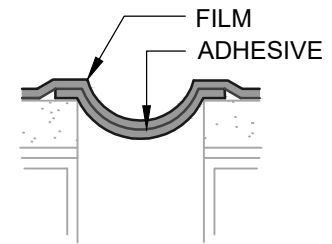

CONCAVE LOOP FLASHING
"SIAMESE" FLASHING

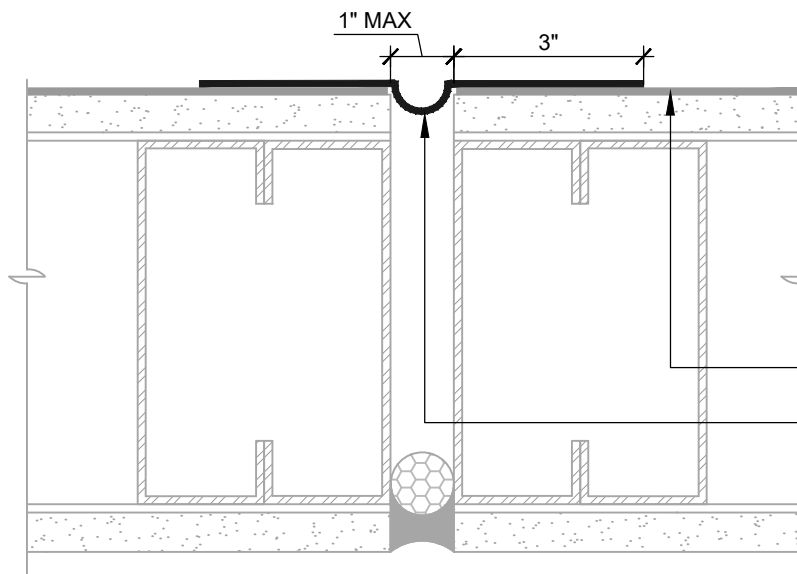

GAPS UP TO 1" MAX (PLAN VIEW)
FLASHING INSTALLED AFTER WRB

BLUESKIN METAL CLAD

BLUESKIN METAL CLAD
(SEE CONCAVE LOOP FLASHING DETAIL)

NOTES:

1. DETAIL SHOWS **BLUESKIN METAL CLAD SELF-ADHERED WATER RESISTIVE AIR BARRIER**. SUBSTRATE SHOWN IS FOR REFERENCE ONLY. ACCEPTABLE SUBSTRATES INCLUDE PLYWOOD, OSB, CONCRETE, CMU, METAL, AND EXTERIOR GRADE SHEATHING.
2. SELF-ADHERED MEMBRANE PRIMER NOT SHOWN FOR CLARITY.
3. OTHER FLASHING OPTIONS INCLUDE: **BLUESKIN BUTYL FLASH**, **BLUESKIN SA** OR **BLUESKIN SA LT**.
4. INSTALL **BLUESKIN METAL CLAD** TO ACHIEVE A CONTINUOUS WATER-RESISTIVE BARRIER (WRB). INSULATION AND CLADDING NOT SHOWN FOR CLARITY.
5. REFER TO PRODUCT SPECIFIC TECHNICAL DATA SHEET (TDS) AND **BLUESKIN METAL CLAD** GUIDE SPECIFICATION FOR INSTALLATION PROCEDURES.

MANUFACTURER GUIDE DETAILS ARE FOR REFERENCE ONLY. HENRY DOES NOT ASSUME RESPONSIBILITY FOR ERRORS OR DEVIATIONS IN DESIGN OR ENGINEERING. PROJECT SPECIFIC VERIFICATION IS RECOMMENDED PRIOR TO INSTALLATION.

BLUESKIN METAL CLAD SELF-ADHERED AIR BARRIER

NON-MOVING JOINTS

SUBSTRATE GAPS UP TO 1" WIDE MAXIMUM
SELF-ADHERED FLASHING

SCALE: N.T.S. 01-09-2020

MTLCLD-8B

Henry[®]

999 N. Pacific Coast Highway, Suite 800
El Segundo, CA 90245
800-486-1278 • www.henry.com